

PROJECT
**LANCASTER CITY CENTRE
 MIXED-USE DEVELOPMENT**

DRAWING
OTHER APPLICATIONS

DRAWING No.
043018 - D - 03 J

REV J 27.04.07 ISSUE TO LANCASTER CITY COUNCIL CK

OUTLINE PLANNING

REVISIONS

SCALE	DATE	DRAWN	CHECKED
1:1250 @ A3	January 2007	CK	SA

- KEY**
- OUTLINE APPLICATION BOUNDARY
 - OTHER APPLICATIONS BOUNDARY
 - APPLICATION NUMBER 6a
 - FLANK WALL APPLICATION BOUNDARIES TO ENCOMPASS THE LISTED BUILDING.
 - EXISTING BUILDINGS TO BE RETAINED

FOR ILLUSTRATIVE PURPOSES ONLY

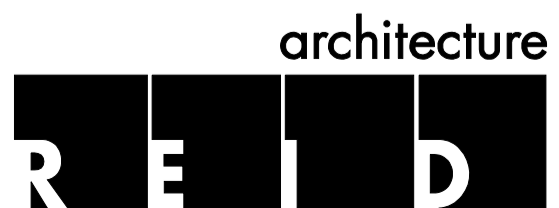

12 Caroline Street Birmingham B3 1TR
 Tel 0121 212 2221 Fax 0121 236 2709 Email reidarchitecture@ra-birm.com